

31 July 2020

**Addendum Number One**

To

Drawings and Specifications Dated July 10, 2020 – 100% MSHA Set

**Lewis Emery Apartments**

**Westbrook, ME**

By

Archetype, P.A.

48 Union Wharf

Portland, Maine 04101

*This addendum modifies, amends and supplements designated parts of the Contract Documents, Project Manual and Drawings for “Oriole Way, Ellsworth” and is hereby made an integral part thereof by reference and shall be as binding as though inserted in its entirety in the locations specified herein. It shall be the responsibility of the General Contractor to notify all Subcontractors and suppliers he/she proposes to use for the various parts of the work of any changes or modifications contained in this addendum.*

**MODIFICATION / AMENDMENT / CLARIFICATION TO THE TECHNICAL SPECIFICATIONS**

1. **Modification: Section 07 31 00, ASPHALT SHINGLE ROOFING SYSTEM.** Omit Section 07 31 00, Asphalt Shingle Roofing System and replace with Section 07 31 13, Asphalt Shingle Roofing System included in this Addendum below.
2. **Clarification: Section 07 42 33, PHENOLIC WALL PANELS** In 2.2, A.5, Color is to be selected by architect from the Trespa ‘Wood Decors’ range of colors.

**MODIFICATION / AMENDMENT / CLARIFICATION TO THE DRAWINGS**

1. **Modification: Revisions to Sheet A6.12, Detail 11, Lavs in Type A and ADAAG Units.** The kneeguard below the lav shown in the section but not in the elevation has been shown on drawing AD1-1. See details on AD1-1 attached below.

**RESPONSES TO BIDDERS’ QUESTIONS**

**See Bidders Questions attached below**

- End of Section -  
Attachments Below

## BIDDERS QUESTIONS AND THE RESPONSES

- The public area door schedule includes interior doors for several 3rd floor units. There are no breakout floor plans for any unit interior door type deviations. Are these additional doors to be included at each of the listed units?

**No, the doors on the 3<sup>rd</sup> floor Public Areas Door Schedule labelled 1 BED UNIT are not to be additionally included in the units. This was due to a software error. The units must receive 'U' labelled doors as indicated on the Enlarged Plans. The only doors that should be on the 3<sup>rd</sup> floor Public Areas Door Schedule are doors 301, 302, & 303.**

- I see in the 100% Plans the Architect is showing substantial voids in the Floor Truss cavities and totally void Roof Truss cavities. Did you ever receive a response on my questions regarding whether or not these voids need to be nearly full to prevent the need to sprinkle the truss cavities?

**The concealed spaces do not need to be sprinkled. And they do not need to be filled. They meet IBC and NFPA as detailed.**

- Is the project taxable or tax-exempt?

**It is taxable**

- I am working on the Trespa quote for this project. The below info is needed to finalize my quote if you could please provide direction:

- 

1) Panel thickness? (8mm,10mm,13mm) **10mm**

2) Panel Color/Finish? (Uni Colour, Wood Decors, Lumen, Metallics, Naturals or Focus).

**To be selected from Wood Decors range of colors**

3) System type? (Exposed fastener or Concealed fastener) **TS210-285 -concealed fastening over fixed depth aluminum sub-framing tested and meeting the performance requirements NFPA 285**

- On page A6.12 detail #11

Elevations indicates the counter to be on brackets

But cut section right next to it outlines having a wall hung ADA unit

Please clarify which it is

**The ADA units will have vanity counters on brackets per the cut section. The kneeguard was mistakenly omitted from the elevation. Please refer to Drawing AD1-1 included with Addendum 1**

- Also the none ADA unit bathroom vanities: I noticed you are installing blocking for future grab bars / are these units to have removable fronts incase of a future change to an ADA unit?

**The ADA bathroom lavs do not have cabinets below – they have the laminate kneeguard as shown on Detail #11. The Type B bathrooms have permanent cabinets below so removable**

**fronts are not required. The blocking for future grab bars is at showers, tubs and WCs in Type B units, the Type A and ADA have grab bars (and blocking) right from the start.**

- On page A8.02 details # 7-8  
1 x 2 trim at jamb and header  
Does this only apply to windows in stairwells?  
**Yes, only in stairwells**

**SECTION 07 31 13**

**ASPHALT SHINGLE ROOFING SYSTEM**

**PART 1 GENERAL**

1.1 SECTION INCLUDES

- A. Granule surfaced asphalt shingle roofing.
- B. Moisture shedding underlayment, eaves, valley and ridge protection.
- C. Associated metal flashing.

1.2 REFERENCES

- A. ASTM D 225 - Standard Specification for Asphalt Shingles (Organic Felt) Surfaced with Mineral Granules.
- B. ASTM D 1970 - Standard Specification for Self-Adhering Polymer Modified Bituminous Sheet Materials Used as Steep Roofing Underlayment for Ice Dam Protection.
- C. ASTM D 3018 - Standard Specification for Class A Shingles Surfaced with Mineral Granules.
- D. ASTM D 3161 - Standard Test Method for Wind-Resistance of Asphalt Shingles (Fan-Induced Method).
- E. ASTM D 4586 - Standard Specification for Asphalt Roof Cement, Asbestos-Free.
- F. ASTM D 6757 – Standard Specification for Inorganic Underlayment for Use with Steep Slope Roofing Products.
- G. ASTM D 7158 – Standard Test Method for Wind Resistance of Sealed Asphalt Shingles (Uplift Force/Uplift Resistance Method)
- H. E 108 - Standard Test Methods for Fire Tests of Roof Coverings.
- I. UL 2218 - Impact Resistance of Prepared Roofing Materials.

1.3 SUBMITTALS

- A. Submit under provisions of Section 01 33 00.
- B. Product Data: Provide manufacturer's printed product information indicating material characteristics, performance criteria, and product limitations.

## Lewis Emery Apartments – Westbrook, ME

- C. Manufacturer's Installation Instructions: Provide published instructions that indicate preparation required and installation procedures.
- D. Certificate of Compliance: Provide Certificate of Compliance from an independent laboratory indicating that the asphalt fiber glass shingles made in normal production meet or exceed the requirements of the following:
  - 1. ASTM E 108/UL 790 Class A Fire Resistance.
  - 2. ASTM D 3161/UL 997 Wind Resistance.
  - 3. ASTM D 3462.
- E. Shop Drawings: Indicate specially configured metal flashing, jointing methods and locations, fastening methods and locations, and installation details, as required by project conditions indicated.

### 1.4 QUALITY ASSURANCE

- A. Maintain one copy of manufacturer's application instructions on project site.
- B. Verify that manufacturer's label contains reference to specified ASTM standards.

### 1.5 ENVIRONMENTAL REQUIREMENTS

- A. Apply each part of the roofing system only when surfaces are clean and dry.
- B. Cover walls and other surfaces in the vicinity of hoisting apparatus (when used) with heavy canvas or other suitable protective material. Any damage caused by this contract shall be repaired to match the original materials and appearance at no cost to the owner.
- C. Conduct operations so as to leave deck exposed for the minimum period of time. Protect the work area as required to prevent water infiltration or environmental damage to building interior.
- D. All material shall be neatly stored, elevated, and protected from damage due to wetness or freezing.
- E. Maintain all site equipment in good working order.
- F. Maintain one copy of manufacturers' application instructions at the project site.

### 1.6 EXTRA MATERIALS

- A. Furnish under provisions of section 01 77 00.

### 1.7 PRE-INSTALLATION MEETING

- A. General: Agenda will include:
  - 1. Installation procedures and manufacturer's recommendations.
  - 2. Safety procedures
  - 3. Coordination with installation of other work.
  - 4. Availability of roofing materials
- B. Timing: The meeting shall take place prior to the start of the roofing installation.

## Lewis Emery Apartments – Westbrook, ME

- C Topics: The ShieldPro-plus+™ Certified contractor and owners representative shall review all pertinent requirements for the project, including but not limited to, scheduling, weather considerations (see section 1.10 below), project duration, product availability, and requirements for the specified warranty (see section 1.11 below).
- D Agenda will include:
  - 1. Installation procedures and manufacturer's recommendations
  - 2. Safety procedures
  - 3. Coordination with installation of other work
  - 4. Availability of roofing materials
  - 5. Preparation and approval of substrate and penetrations through roof
  - 6. Other items related to successful execution of work

### 1.8 WEATHER CONDITIONS

- A. Proceed with work only when existing and forecasted weather conditions will permit work to be performed.
- B. When application conditions might limit the effectiveness of the sealing strip, such as in cool weather or in areas subject to high winds or blowing dust, shingle adherence should be ensured through manual sealing.

### 1.9 WARRANTY SUPPLEMENT

- 1. Provide manufacturer's supplemental warranty to cover labor and materials in the event of a material defect for the following period after completion of application of shingles:
- 2. Extended Warranty Protection
- 3. Warranty Transferability Clause: Make available to the owner
- 4. Shingle warranty to be a minimum of 30 years.

## **PART 2 PRODUCTS**

### 2.1 MANUFACTURER

- A. Provide products manufactured by CertainTeed Corporation or GAF.

### 2.2 ASPHALT FIBER GLASS SHINGLES

- A. Acceptable Manufacturer: CertainTeed or GAF.
- B. GAF Timberline Ultra HD or Certain Teed Landmark TL

### 2.3 MATERIALS

- A. Color to be selected by the Architect.

## Lewis Emery Apartments – Westbrook, ME

- B. All primary roofing products, including shingles, underlayment, and Ice & Dam protection are to be supplied by a single manufacturer.

1. Asphalt Shingles: Class "A" fire resistance rating, in conjunction with an approved underlayment.
2. Roof Protection: Roof eave protection shall consist of 1.8-mm Ice & Water protector underlayment s required by the Local Building Codes and designer.
3. Felt Underlayment: 1 ply, 15lb non-perforated asphalt impregnated felt conforming to ASTM D 4869 Type II or CSA A123.2 Asphalt Coated Roofing Sheets. Underlayment is mandatory for slopes under 8:12. Synthetic underlayment is also acceptable.

Valley underlayment construction consists of an additional full-width sheet of ASTM D4869, Type I or Type II (No. 15) or ASTM D4869, Type III or Type IV (No. 30) asphalt-saturated underlayment felt or polymer-modified bitumen underlayment, base sheet, or water and ice-dam protection membrane

### 2.4 HIP AND RIDGE SHINGLES

- A. Three-tab shingles of the same color and by the same manufacturer may be cut and used for the hips and ridges.

### 2.5 FLASHING MATERIALS

- A. Sheet Flashing: ASTM B 209; 0.025 in (0.63 mm) thick aluminum, mill finish.
- B. Sheet Flashing: ASTM B 370; cold rolled copper; 16 ounces per square foot (0.55 mm); natural finish.
- C. Bituminous Paint: Acid and alkali resistant type; black color.
- D. Tinner's Paint: Color as selected by Architect to coordinate with shingle color.
- E. Drip edge formed from minimum .32 aluminum.

### 2.6 ACCESSORIES

- A. Nails: Standard round wire type roofing nails, corrosion resistant; hot dipped zinc coated steel, aluminum, or chromated steel; minimum 3/8 inch (9.5 mm) head diameter; minimum 11 or 12

## Lewis Emery Apartments – Westbrook, ME

gauge (2.5 mm) shank diameter; shank to be of sufficient length to penetrate through roof sheathing or 3/4 inch (19 mm) into solid wood, plywood, or non-veneer wood decking.

- B. Asphalt Roofing Cement: ASTM D 4586.

### 2.7 FLASHING FABRICATION

- A. Form flashing to profiles indicated on Drawings, and to protect roofing materials from physical damage and shed water.
- B. Form sections square and accurate to profile, in maximum possible lengths, free from distortion or defects detrimental to appearance or performance.

## PART 3 EXECUTION

### 3.1 EXAMINATION

- A. Verify existing site conditions under provisions of Section 01 45 00.
- B. Verify that roof penetrations and plumbing stacks are in place and flashed to deck surface.
- C. Verify roof openings are correctly framed prior to installing work of this section.
- D. Verify deck surfaces are dry and free of ridges, warps, or voids.

### 3.2 ROOF DECK PREPARATION

- A. Follow shingle manufacturer's recommendations for acceptable roof deck materials.
- B. Broom clean deck surfaces under eave protection and underlayment prior to their application.

### 3.3 INSTALLATION - EAVE ICE DAM PROTECTION

- A. Place eave edge and gable edge metal flashing tight with fascia boards. Weather-lap joints 2 inches (50 mm). Secure flange with nails spaced 8 inches (200 mm) on center.
- B. Apply Grace Ice and water shield as eave protection in accordance with manufacturer's instructions.
- C. See roof drawings for locations.

### 3.4 INSTALLATION - PROTECTIVE UNDERLAYMENT

- A. Cover entire roof slope with underlayment membrane, or as directed on drawings.



## Lewis Emery Apartments – Westbrook, ME

- B. Weather-lap and seal watertight with asphalt roofing cement items projecting through or mounted on roof. Avoid contact of solvent-based cements with Ice and Water Shield.

### 3.5 INSTALLATION - VALLEY PROTECTION

- A. For "closed-cut," "woven," and "open" valleys first place one ply of Ice and Water Shield. Lap joints minimum 6 inches (152 mm). Follow instructions of shingle and waterproofing membrane manufacturer. Cover entire roof with underlayment.

### 3.6 INSTALLATION - METAL FLASHING

- A. Weather-lap joints minimum 2 inches (50 mm).
- B. Seal work projecting through or mounted on roofing with asphalt roofing cement and make weather-tight.

### 3.7 INSTALLATION - ASPHALT SHINGLES

- A. Install shingles in accordance with manufacturer's instructions for product type and application specified.

### 3.8 FIELD QUALITY CONTROL

- A. Field inspection will be performed under provisions of Section 01 45 00.

### 3.9 PROTECTION OF FINISHED WORK

- A. Protect finished work under provisions of Section 01 77 00.
- B. Do not permit traffic over finished roof surface.

**END OF SECTION**

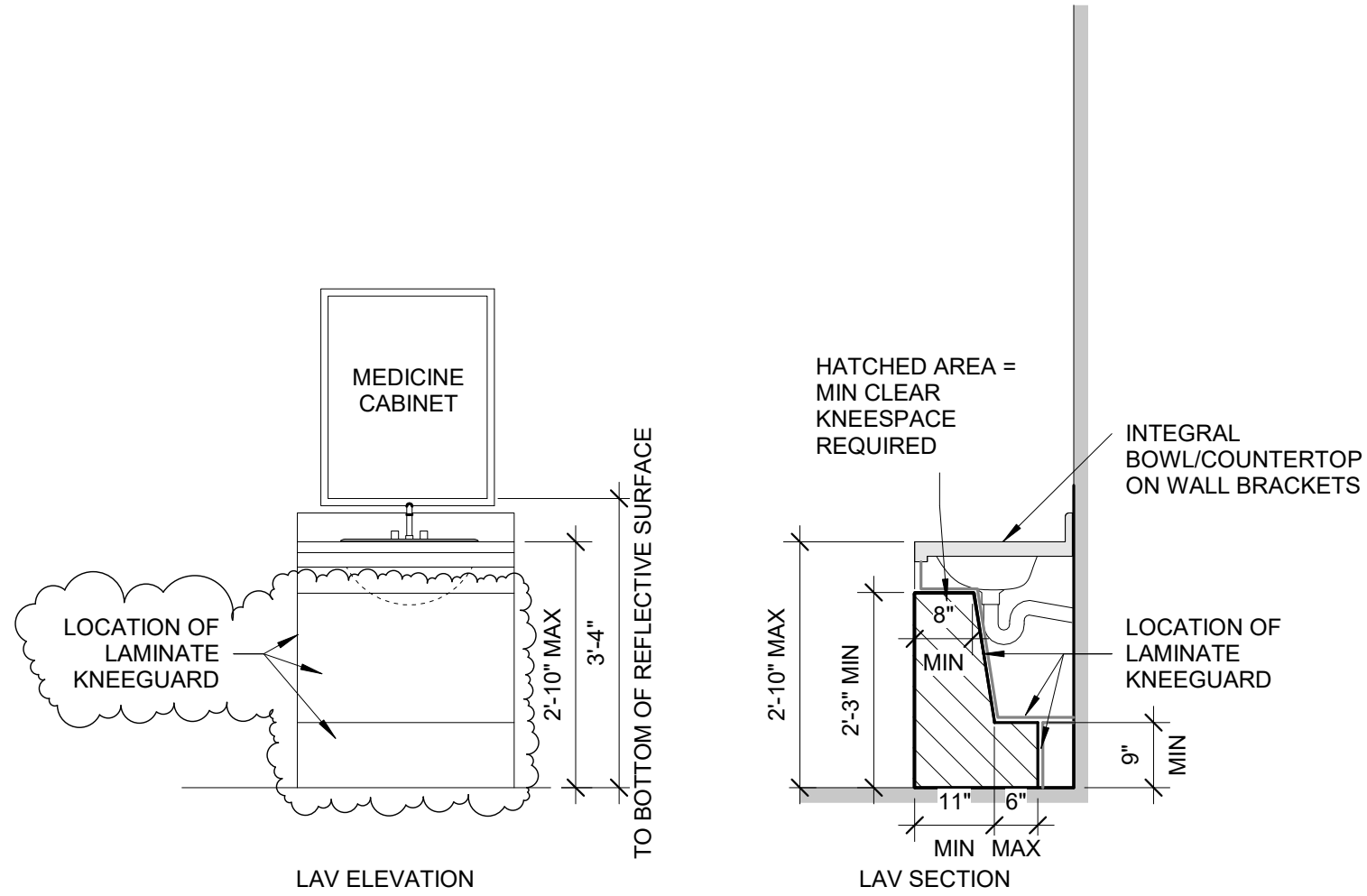

**1** | LAV. ELEV. - ADAAG & TYPE A UNITS Copy 1  
 1/2" = 1'-0"