



Addendum #2 6/8/2020
Newton Place PENQUIS Grandview Ave., Bangor

Reference Architectural Bidding Documents dated April 16, 2020

Note: Please note the receipt of this addendum in your bid.

2 Pages, including SK-A1.

General Items

1. None

Specification Items

2. **07 21 00**, Insulation
 - a. Para 3.2, A. 1. Change: Full thick insulation is not always required. Insulate as indicated below along with any thicknesses as noted.

Drawing Items

3. **Drawing A0**, Clarification, The intent per the spec is for mineral wool batts in all interior partitions. Per note #2, full-thick glass fiber may be used except walls in the basement to be mineral wool.

Mineral wool will be used in the exterior walls.

6" Glass fiber insulation for all floor/ceilings including the corridors except third floor ceiling. This is indicated on 1/A6 but not shown everywhere. Ignore the notes that indicate rock wool here. Otherwise all ceilings are to be included.
4. **Drawing A5.1**, Change: See attached SK-A1 for construction and insulation at stair ceiling.
5. **Drawing A6**, Detail 3, Clarification of cantilevered second floor insulation: 6" glass fiber in floor with 2" foil-faced iso-board under the assembly.
6. **Drawing A8**, Change: Any of the rated doors of style B may be primed wood as long as the rating is maintained. If they are steel as indicated, the panel affect can be created with add-on trim.

End of Addendum #2

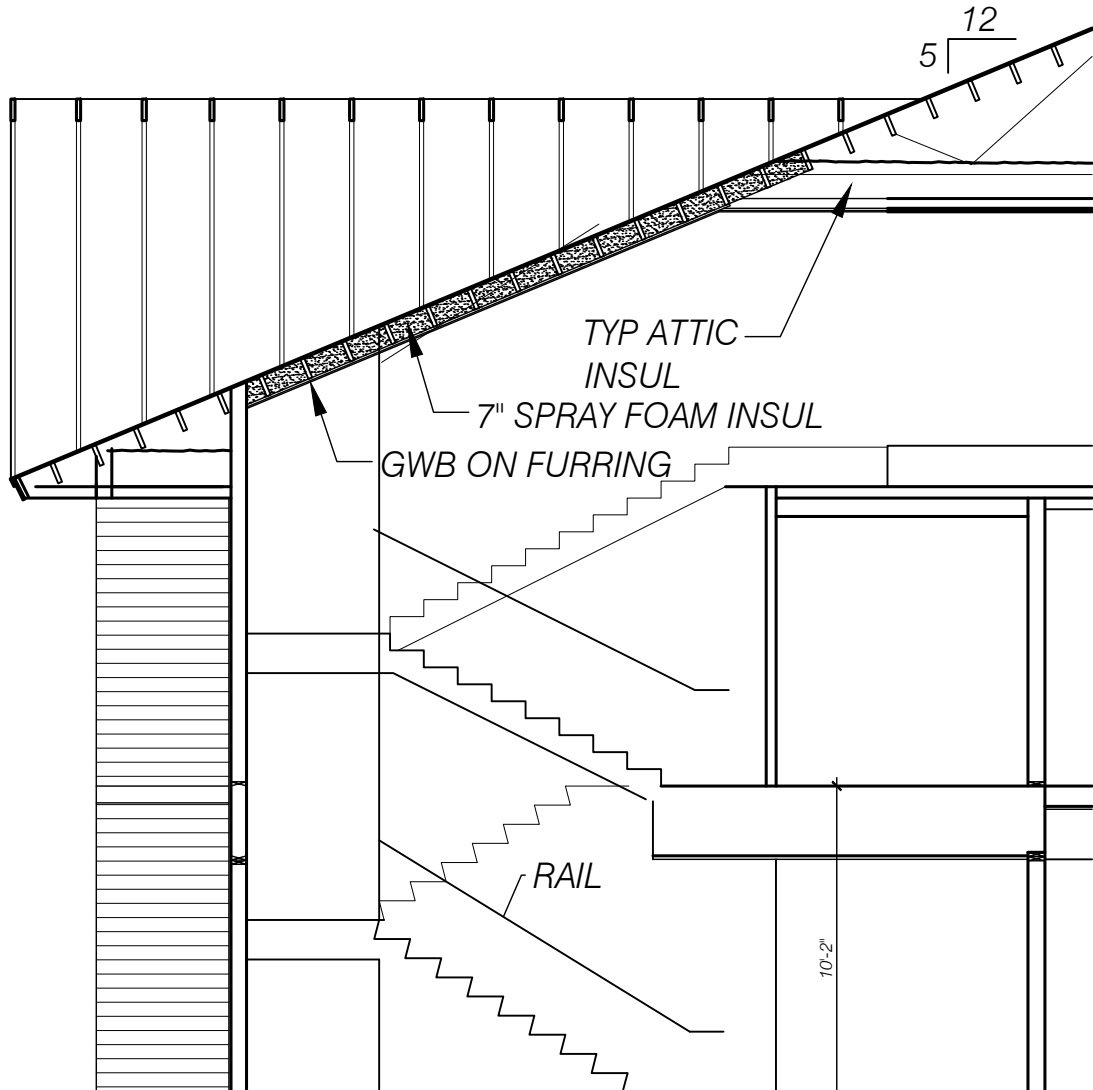

CENTER STAIR

SCALE : NONE

1



Newton Place
Center Stair Ceiling

Drawn: *drm*
 Checked: *drm*
 Date: 06/5/20
 Project No: 21924

SK-A1