



Addendum #1 6/2/2020
Newton Place PENQUIS Grandview Ave., Bangor

Reference Architectural Bidding Documents dated April 16, 2020

Note: Please note the receipt of this addendum in your bid.

3 Pages, including (1) SK.

General Items

1. The IBC building construction type is 5B, Unprotected wood construction.

Specification Items

2. **Bid Form** Item 8, Clarification: “Local Permits” are defined as the building permits. State Fire Marshal permit is by the Owner. Site plan permits have been secured.
3. **Bid Form**, Unit Prices, Item C, Clarification: The Unit price for Select Fill shall include excavation and disposal of unsuitable materials.
4. **Bid Form**, Allowances, Clarification: There will be no allowance for the natural gas hook-up. The GC will be responsible for all work on the building side of the regulator.
5. **01 50 00**, Para. 1.11, Clarification: The amount and location of fencing and/or barriers is at the GC’s discretion.
6. **06 18 10**, Add: Para 2.1C, Trus Joist LVL is an accepted product.
7. **08 43 13**, Change: 2.4 A. See hardware to be supplied by the hardware section (08 71 00, Para 3.08.1., Items 1 and 2. All else is by aluminum door supplier. All hardware is installed by the aluminum door supplier.
8. **10 28 13**, page 3, Add: Toilet paper holder can be Moen Method YB2408BN, nickel finish. Towel bar can be Moen Method YB2418BN and YB2424BN.
9. **21 13 00**, 1.8.A.1, Delete the reference to a partial NFPA 13 system. The system will be entirely 13R.
10. **33 46 00**, 3.6A, Clarification: Perimeter footing drains are interior and exterior per drawing S5.1, Detail 1.

Drawing Items

11. Drawing **C10**,
 - a. Chain Link fence details, Add: See attached SK-001 for revisions.
 - b. Chain link fence details, Add: a 3 ft wide side door to the dumpster enclosure for accessibility.
12. Drawing **A1.2**, Add: a wall mounted, bracket type fire extinguisher in the mechanical space.
13. Drawing **A6.1**:
 - a. Detail1, Add: suspended ceiling in corridor per other drawings.
 - b. Details 1 and 2, Add: Insulate corridor floors.
14. Drawings **A5**, **A5.1**, Clarification: The vertical shafts near the footing levels represent approximate boring locations. The B-# designations correlate with the Boring Log in the appendix of the project manual.
15. Drawing **A11**,
 - a. Change: The spaces on the finish schedule noted as "Center Corridor" are included with the Lobby and Common Spaces on each level. They shall have LVT finish and chair-rails/handrails where noted.
 - b. Change: The finish legend will be changed to include VSB(vinyl straight base) and VCB (vinyl cove base) and can then be coordinated with the schedule. Change all vinyl base to 4" high.
 - c. Change: Finish Legend, for Lobby 100, Common 200, and Common 300 add chair-rail and handrail as shown on the plan. They do not occur together.
16. Drawing **S1.1**, Add, Provide/install a 200 SF 4" concrete pad as shown and described on Sheet M1 for the boilers and tanks.
17. Drawing **S5.1**, Clarification: The rebar and grout indicated for the elevator shaft extend to the top of the shaft.
18. Drawing **M2**, Clarification: RG-1 in Lobby 100 area shall be 12"x12", adjust ductwork as required to eliminate noise concerns.
19. Drawing **M2**, **M3**, **M4**, Clarification: SD-3/SD-4 diffusers in common area shall be installed utilizing a square cone diffusers. Each diffuser shall be rated for the CFM and static pressure as shown on the plans. Modify supply ductwork and dampers as required to ensure adequate airflow within the space served.
20. Drawings **E2-E4**: Clarification: Tenant electrical panels shall be mounted with the top breaker at 48" A.F.F.
21. Drawing **FP-1**, Clarification: In the legend "Speaker/Strobes" are Horn/Strobes.

End of Addendum #1

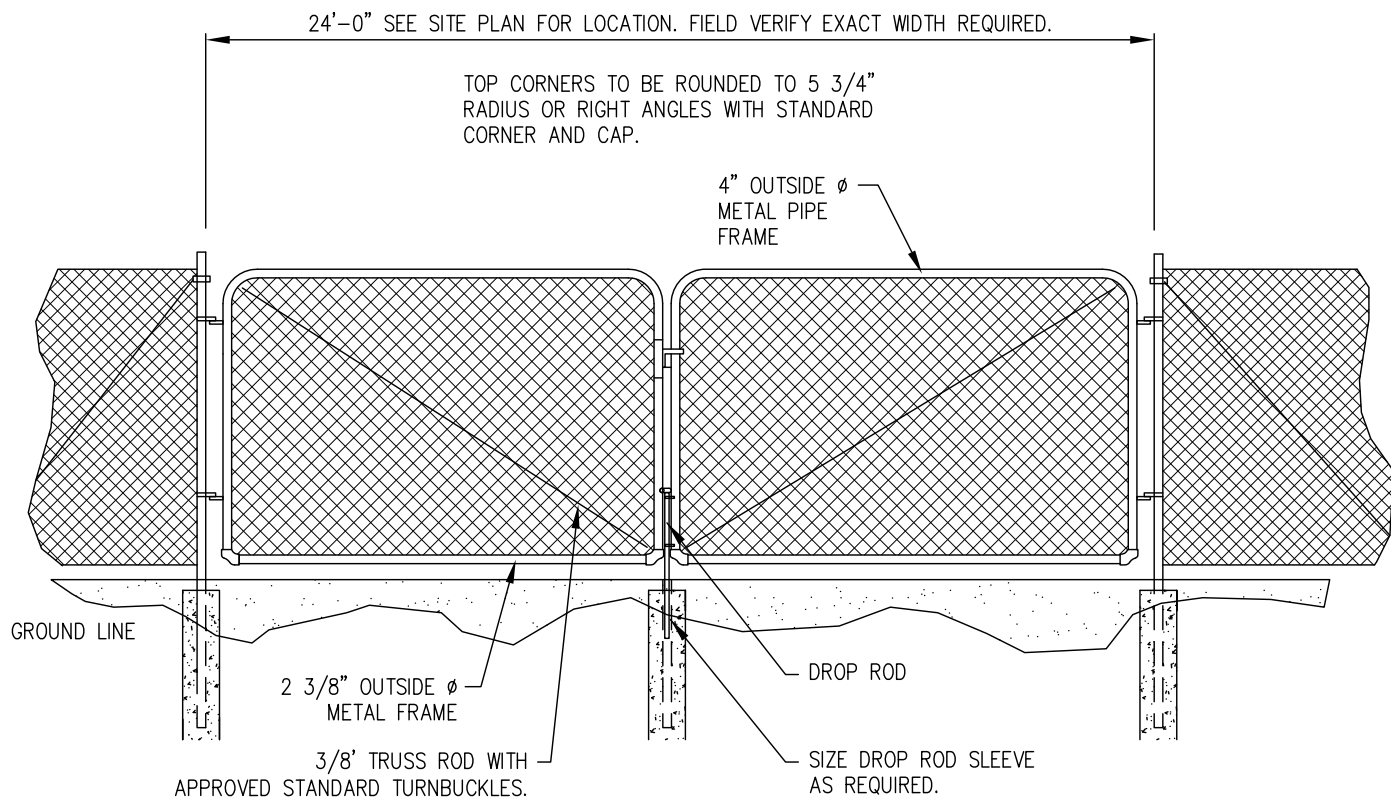

NOTE:

CONCRETE SONOTUBE POST FOUNDATIONS SHALL BE UTILIZED AT ALL CHANGES IN GRADE AND DIRECTION AND AT BOTH SIDES OF ANY GATES OR OPENINGS. DEPTH OF FOUNDATION SONO-TUBES SHALL EXTEND BELOW FROST LEVEL.

CHAIN LINK GATE DETAIL

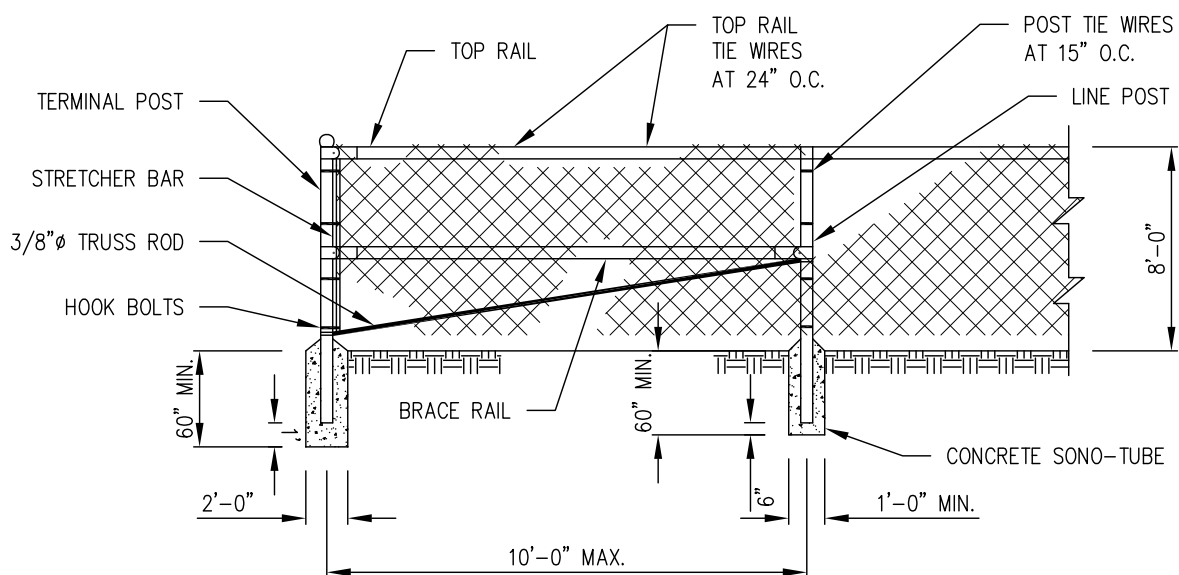

NOTE:

1. WHEN LEDGE IS ENCOUNTERED STEEL POSTS SHALL BE SET AND GROUTED 12" DEEP UNLESS THE POSTS PENETRATE THE GROUND TO A MINIMUM DEPTH OF 3 FEET.
2. WHEN THE WORD "STANDARD" IS USED, INTERPRET IT AS IF IT WERE FOLLOWED BY THE WORDS, "TO THE FENCING INDUSTRY".
3. CONCRETE FOR POST FOUNDATIONS SHALL BE MDOT CLASS B.
4. IN WELL FORMED HOLES WITH VERTICAL WALLS, FORMS WILL BE REQUIRED ONLY AT THE TOP 9 INCHES. HOLES WHICH CAN NOT BE WELL FORMED SHALL HAVE FORM FOR THE FULL DEPTH OF THE BASE.
5. GATE POSTS, BRACES AND ANCHORS TO BE AS SPECIFIED UNDER CHAIN LINK FENCING METAL POSTS.
6. ALL GATES SHALL BE INSTALLED WITH THE TOP HINGE PIN POINTING DOWN.
7. WIRE FOR GATES SHALL CONFORM TO ASTM A116, CLASS 1, DESIGN NO. 1047-12-11.
8. THE REQUIRED FITTINGS FOR FENCE AND GATES SHALL BE STEEL OR MALLEABLE IRON OF APPROVED STANDARD TYPE.
9. GATES SHALL BE FURNISHED WITH STANDARD FORK LATCH AND ONE PIECE OF 3/16" STRAIGHT LINK, ALLOY STEEL CHAIN, 24" LONG. ONE END SHALL BE ATTACHED TO THE GATE FRAME AND SHALL BE ATTACHED TO THE OTHER END AND SHALL BE A SNAP LOCK OR OTHER APPROVED FASTENING DEVICE.

CHAIN LINK FENCE DETAIL

NOT TO SCALE

Copyright: Reuse or reproduction of the contents of this document is not permitted without written permission of CARPENTER ASSOCIATES

100% BID SET
04-16-2020

SK-001

Sheet Number:
2020013

Project No:
2020013

Checked: RIB
Scale: AS NOTED
Date: 06-02-2020

Drawn: JE

PENQUIS HOUSING
NEWTON PLACE
GRANDVIEW AVE. BANGOR, MAINE

CHAINLINK FENCE DETAIL

REVISIONS

NO	DATE	DESCRIPTION

CARPENTER ASSOCIATES
CONSULTING ENGINEERS
687 STILLWATER AVENUE OLD TOWN MAINE 04468

